

King-post Roof.

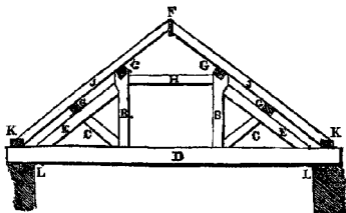

Queen-post Roof.

A, king-post.
 B B, queen-posts.
 C C C C, braces or struts.
 D D, tie-beams.
 E E E E, principal rafters, blades,
 or backs.

F F, ridge-pieces.
 G G G G G G, purlins.
 H, collar.
 J J J J, common rafters.
 K K K K, pole-plates.
 L L L L, wall-plates.